

Get on mainstreet
 in Ennolaugh then
 turn on 43 then go about
 5 miles then turn off
 to F Highway then
 go 2 blocks the you are
 at my house

Turn on to 43 go about
 20 some miles to 54 take
 a left go about 25 miles.

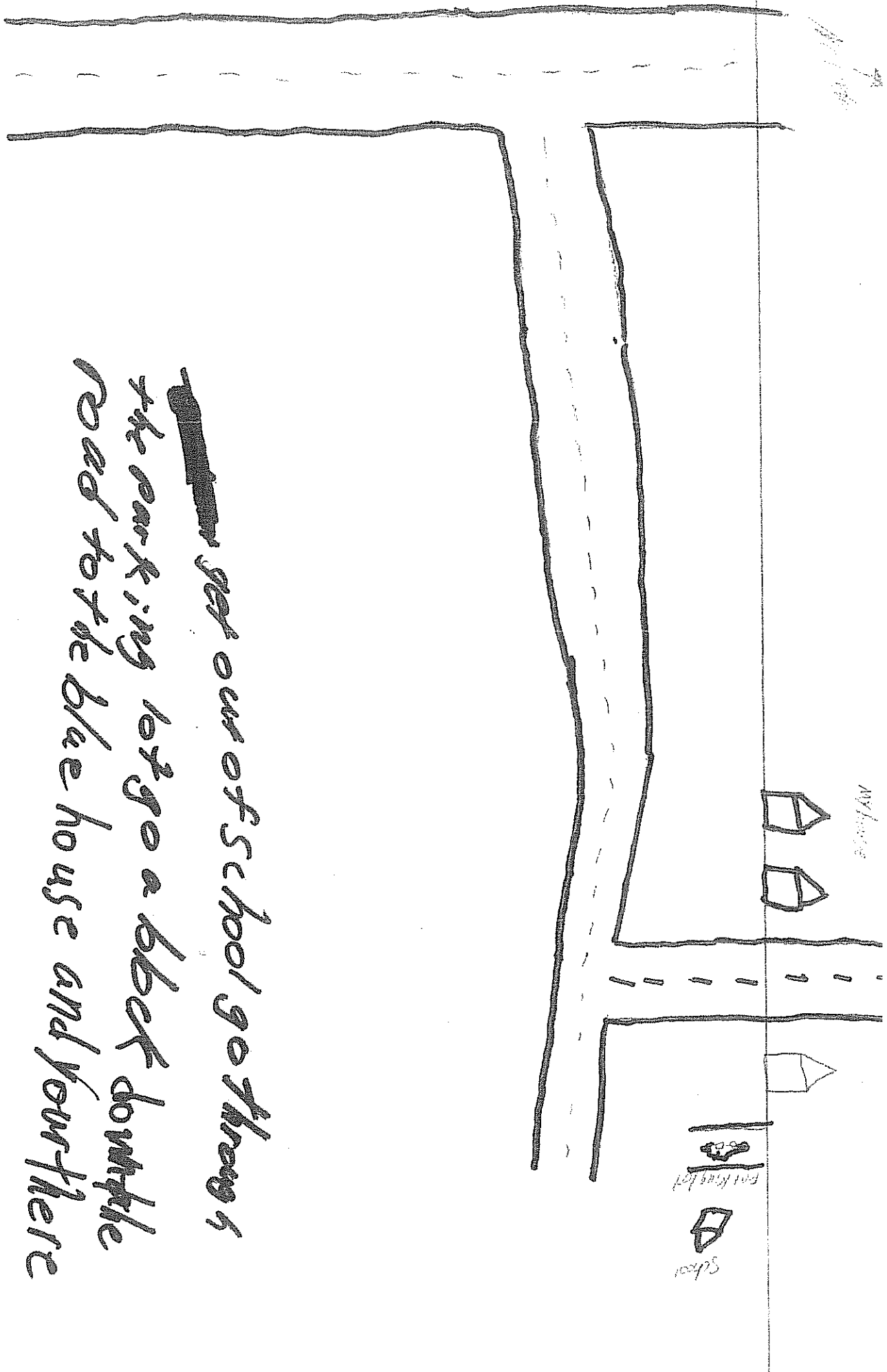

~~in~~ get out of school go through
the parking lot go a block down the
road to the blue house and your there

get for school

- ← If you're in the car park say
- Turn left at intersection
- ← go 4 blocks you at school

North

get from the car park
← back up
go down
then go right on the highway on north side
then go left on the highway
keep driving 97

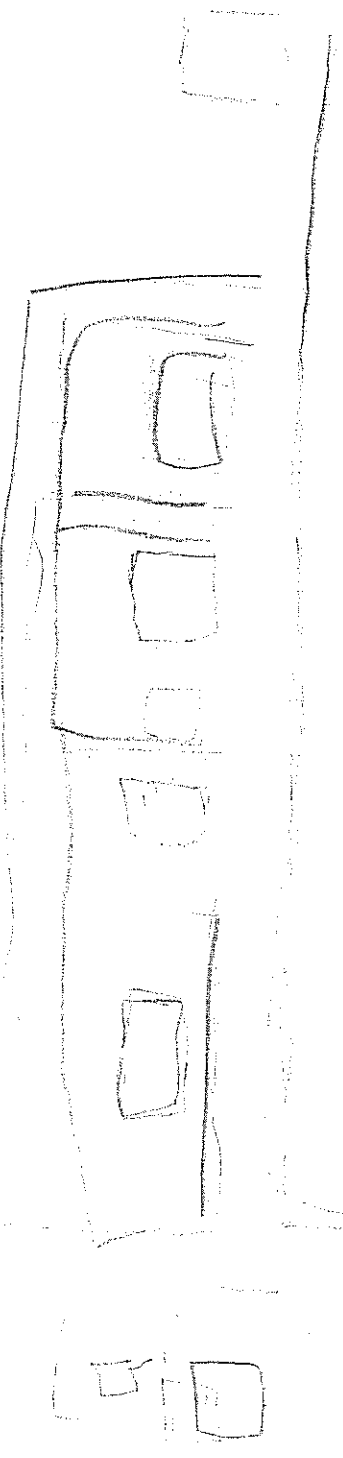

Veranda

Sched

43 Highway

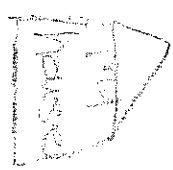

4th Street

Rain track
###



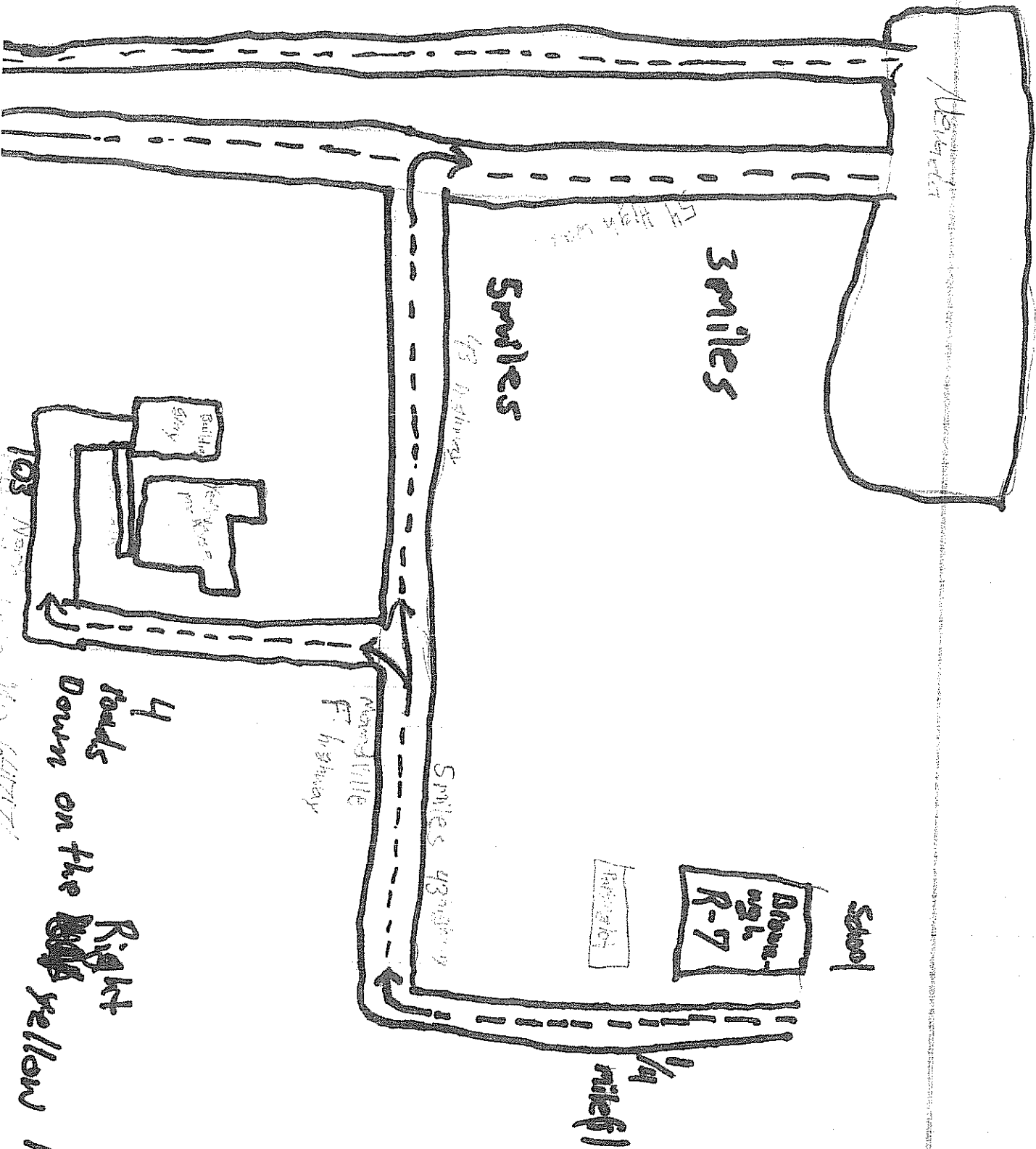

4 roads down on the right yellow house

103

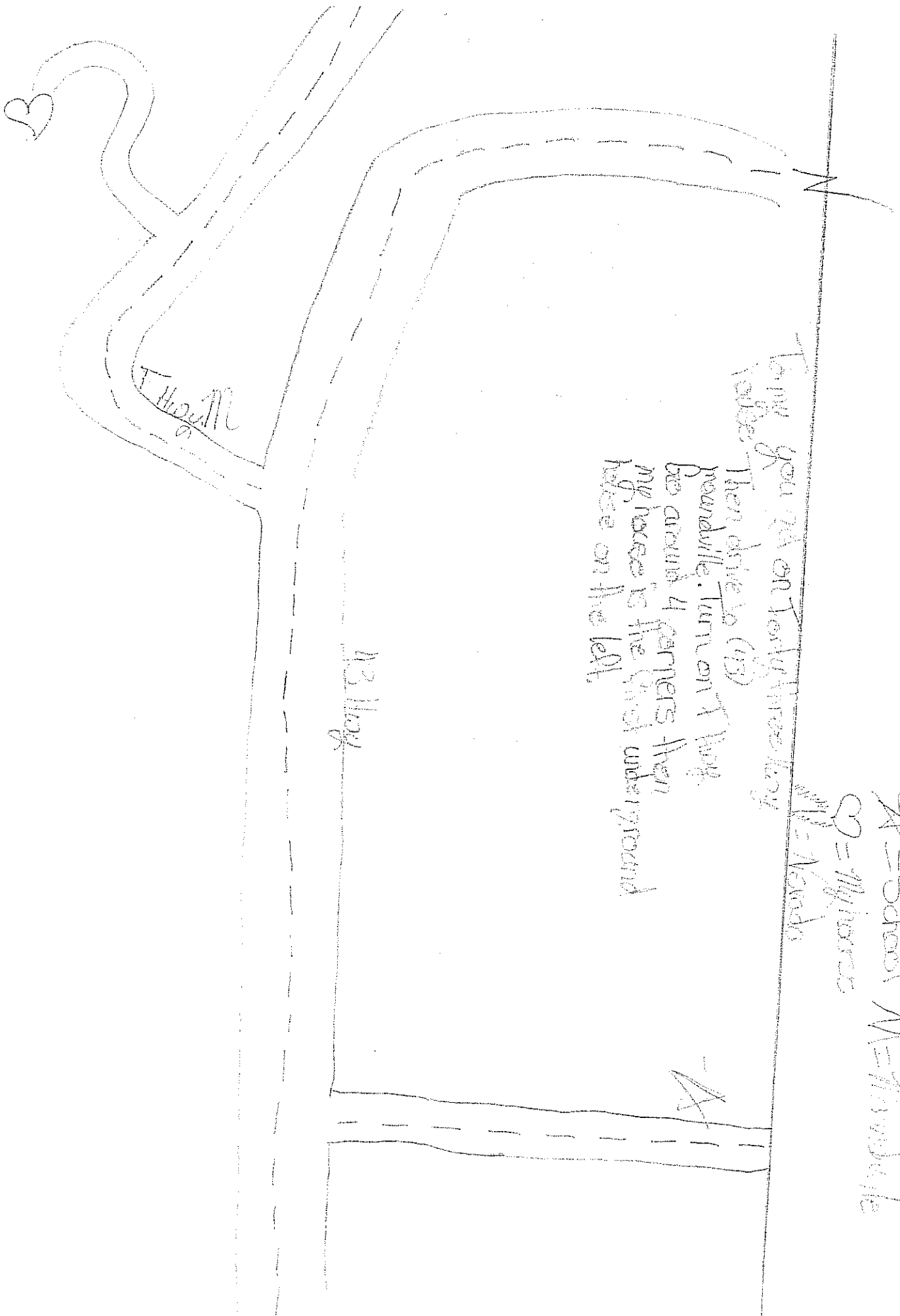

Follow you rd on Fordham road
 (about 1/2 mile) then drive to (123)
 roundville. Turn on 123 Hwy
 go around 4 corners then
 my house is the first underground
 house on the left.

A = School / N = 1100 rd / e
 O = My house
 M = Nevada

A

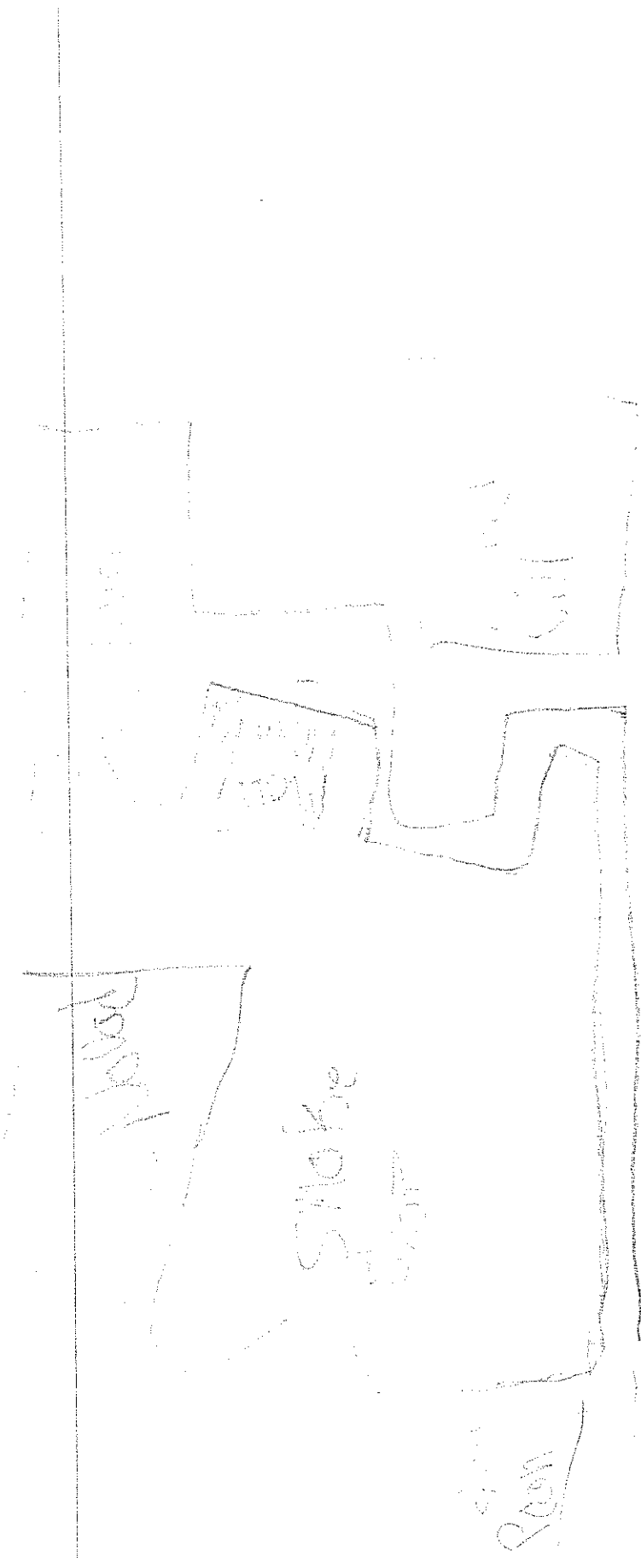

Norabba

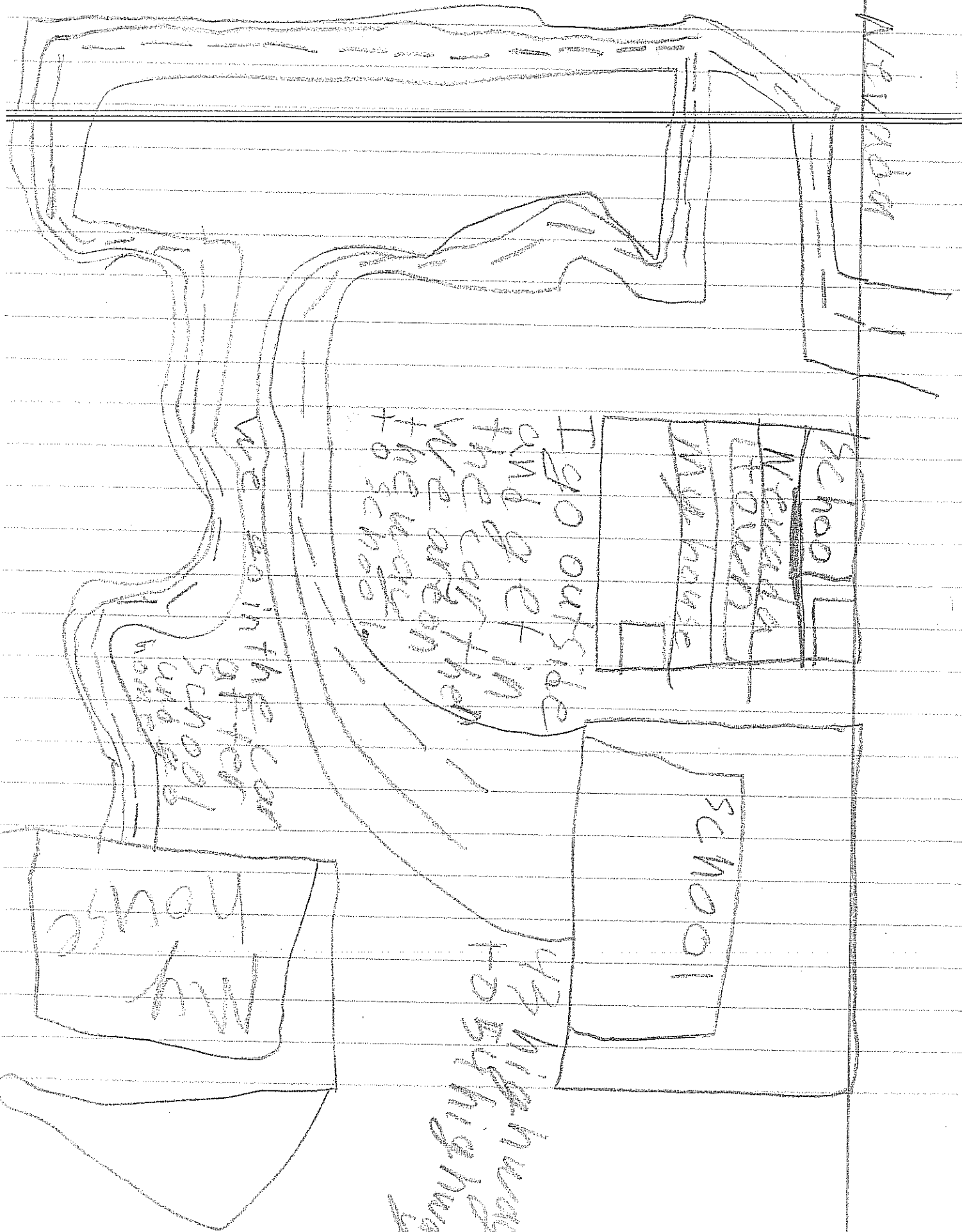

I go outside
and get in
the car then
we are on
the way
to school

we go in the car
at the
school
out to
school
home

my
house

SCHOOL

43 highway
to Bighingwa

School
Towards
town
My house

Go from house to car buckle up
 continue on maple for 3 blocks
 turn Left on 6th street
 Continue for 5 blocks turn
 Right on 43 highway continue
 for 11 miles turn Right on 93
 highway for 3 miles and you
 have reached your destination

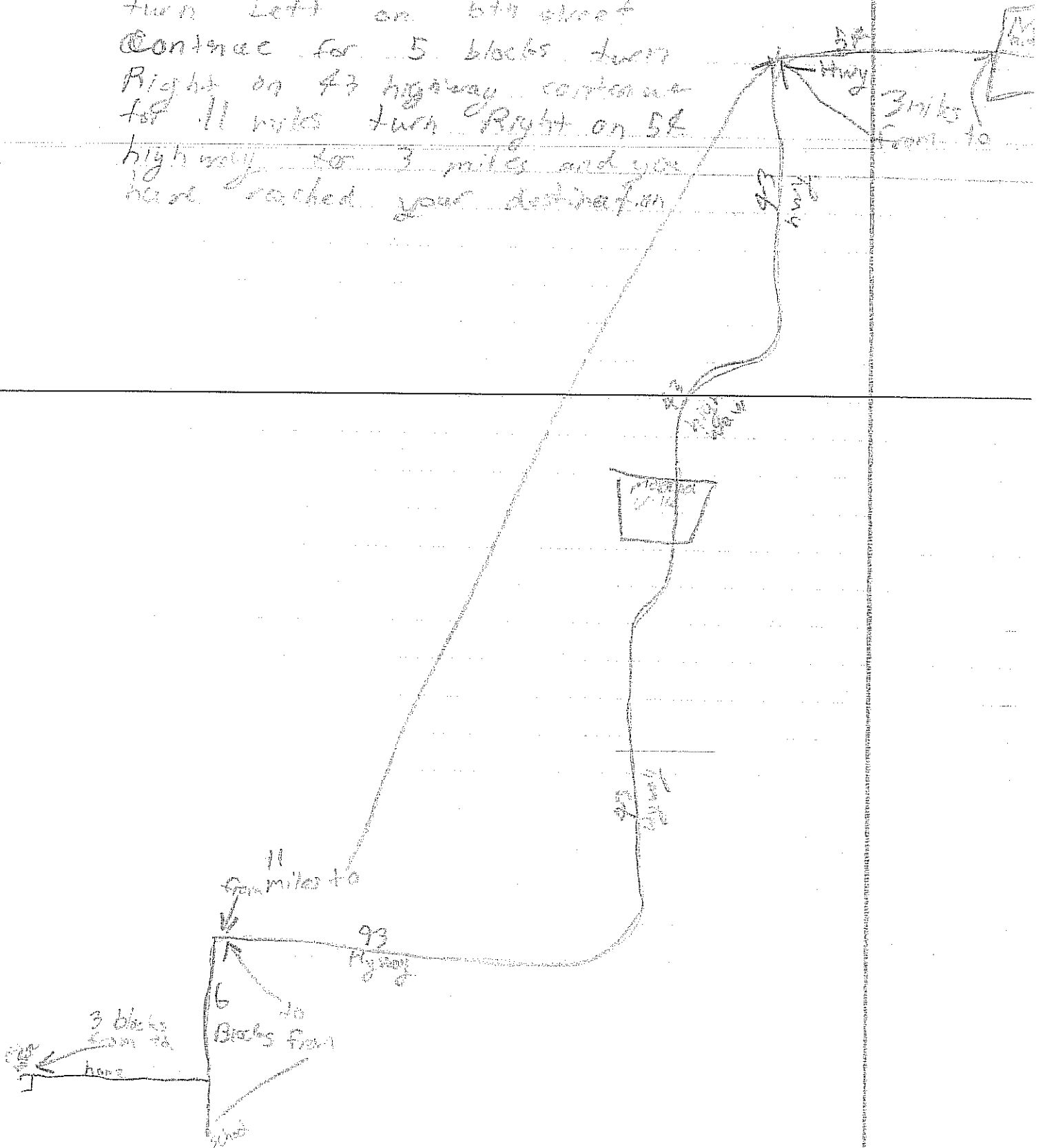

Gravel Road
Gravel becomes
fines on this
road

BB highway

T Williams

43 Highway

Wardner
house

FF highway

Proprietary
school

Parking
lot

My house

Breid's
house

Ed Scott

State line

Stellars

McDonald's

T
Williams

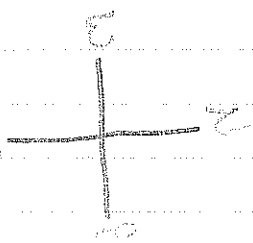

↑
←
from
1000 54200
→
12/1

1000 54200

my ho

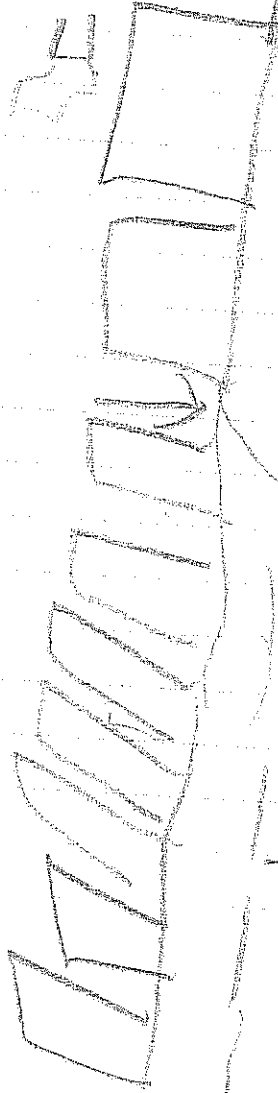

China

1000 54200
two 06 404
from 1000 54200
home effort
to 200 0012
of 1000 54200
my pick up
1000 54200
12/1

